



**Griffco Valve Inc.**  
 188 Creekside Dr  
 Amherst, NY 14228 USA  
 Phone: +1 716 835-0891  
 Fax: +1 716 835-0893  
[sales@griffcovalve.com](mailto:sales@griffcovalve.com)  
[www.griffcovalve.com](http://www.griffcovalve.com)

# M-SERIES PRESSURE RELIEF VALVES



**Griffco M-Series** diaphragm pressure relief valves are designed to protect chemical feed systems from over pressure damage caused by defective equipment or a blockage in the chemical feed line. Robust construction ensures reliability in the rigorous service of municipal and industrial applications. Wetted materials include: **PVC, CPVC, PP, PVDF, PTFE, Halar, 316 SS, A20 and Hastelloy C.** Available sizes: 1/4", 3/8", and 1/2".

## Features:

- **Molded Noryl Top**
- **High Reliability / Low Cost**
- **Compact Size for OEM Applications**
- **Adjustable Pressure Settings**
- **Optional 350 PSI Rated Valve**
- **3 Port, 2 Port, & 90° Configuration**
- **Robust, Machined Body Construction**
- **Multiple Diaphragm Materials**
- **Wide Range of Valve Materials**

## Operation:

**Griffco** diaphragm pressure relief valves operate when the pressure in the chemical system exceeds the preset pressure of the valve. The diaphragm is held against the valve seat by an internal spring. When the preset pressure is exceeded the diaphragm is forced up and the chemical flows out the relief port, back to the chemical tank or to the suction side of the pump. The valves are pre-set at 50 psi, however they are field adjustable from 10 - 150 psi, via the adjustment screw. The relief valve should be set approximately 15 psi higher than the system pressure. Installation should be made as close to the pump as possible, without any valves or accessories between the relief valve and the pump. Consult your pump manufacturer for their recommendations.

## TYPICAL INSTALLATION

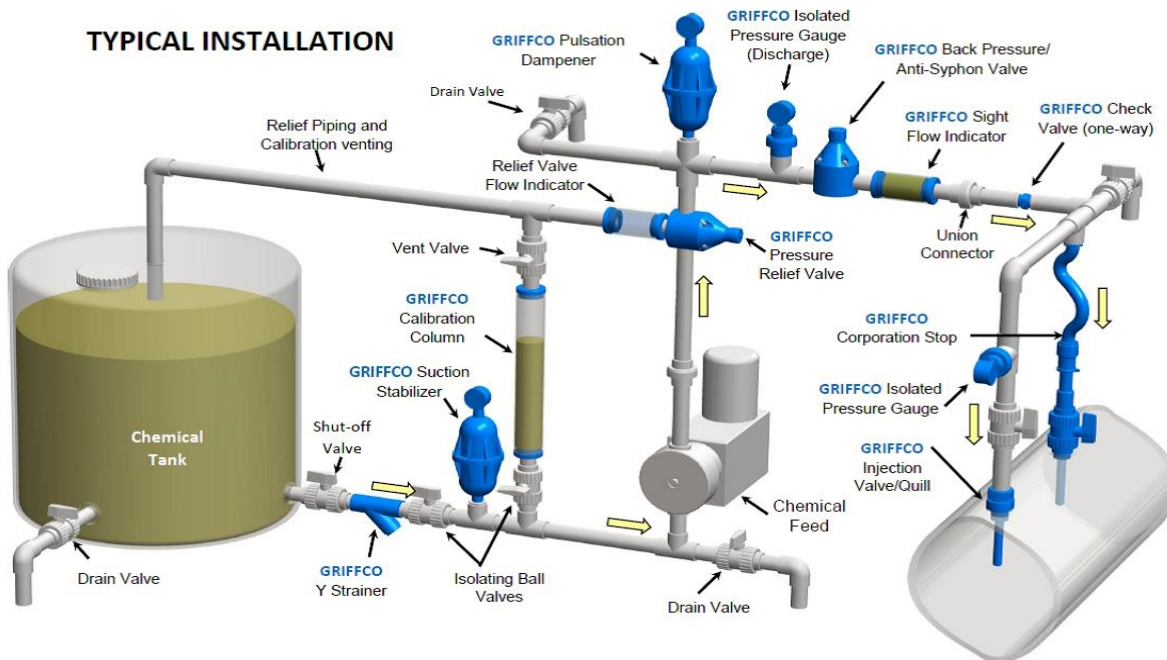

## Technical Data:

Sizes: PRM			1/4", 3/8", 1/2"		
Connections:			NPT, Socket, Union, Flanged		
Pressure Adjustment			Standard 10 - 150 psi, Optional: 0 - 50 psi, 10 - 250 psi, 50 - 350 psi		
Flow Rates @ 150 psi			Shipping Weight: lbs		
Size	Pulsating	Continuous	Plastic	Metal / Plastic Top	Metal / Metal Top
1/4"	100 USgph	5 USgpm	1.0	2.5	3.0
3/8"	200 USgph	10 USgpm	1.0	2.5	3.0
1/2"	300 USgph	15 USgpm	1.0	3.0	3.5
Max Temperature: (°F)			PVC: 140°; CPVC & PP: 195°; PTFE & PVDF & Metal: 300°, (Peak 390°)		
Max Operating Pressure @ 70°F: (psi)			Plastic/Noryl: 375 psi, Metal /Metal: 2000 psi		
Materials of Construction:					
Diaphragm			PTFE / EPDM, Optional: Viton, Hypalon, Nitrile, PTFE / Viton		
Valve Top			Standard: Noryl, Optional: 316 SS L		
Valve Body			PVC, CPVC, PP, PTFE, PVDF, 316 SS L, A 20, Hast. C, Others on Request		

## Performance Curves:

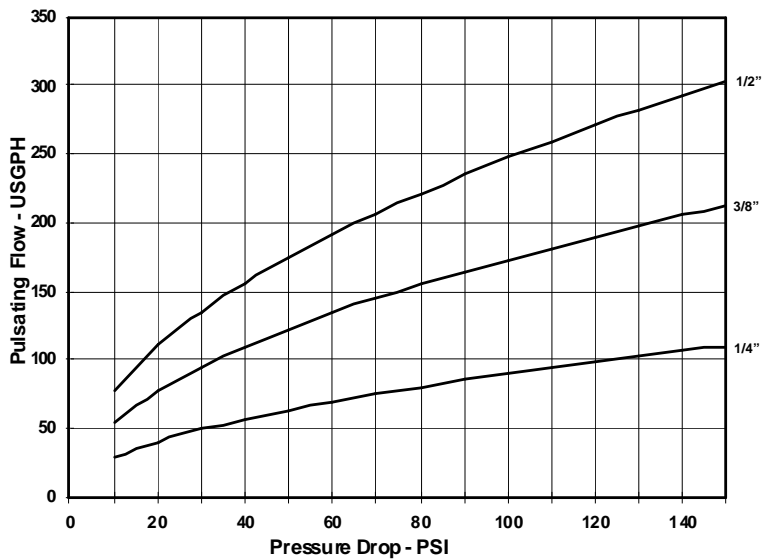

## Standard PRM Dimensions:

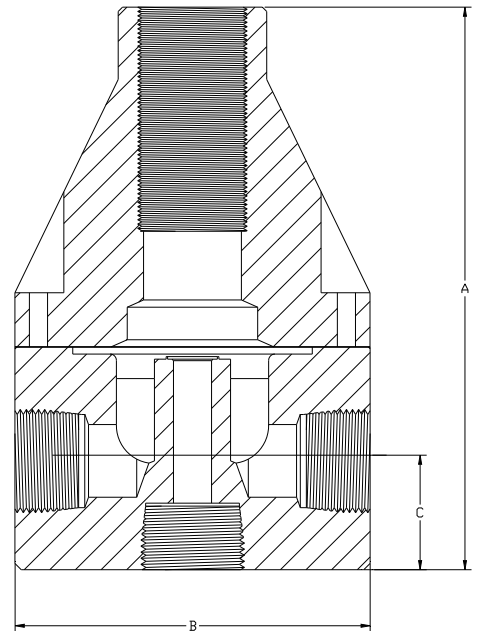

\*PRM2 and PRM3 Dimensions available upon request

## Product Codes For Ordering:

PRM ☐ ☐ ☐ ☐ ☐ ☐

PRM2 (Optional 2 port) 1 2 3 4

PRM3 (Relief port is on the side of the valve instead of at the bottom)

### 1 = Size

025 - 1/4"  
038 - 3/8"  
050 - 1/2"

### 2 = Material

P - PVC  
CP - CPVC  
PP - Polypro  
T - PTFE  
K - PVDF  
H - Halar  
S - 316 SS  
A - Alloy 20  
C - Hastelloy C

### 3 = Spring Opt

Blank - 10-150 psi  
1 - 0 - 50 psi  
2 - 10 - 250 psi

For 50 - 350 psi  
spring use option  
code "MSS"

### 4 = Options

Blank - NPT & PTFE/EPDM  
V - Viton Diaphragm  
TV - PTFE/Viton Diaph.  
S - Socket Connection  
F - Flange Connection  
U - Union Connection  
OSS - 316 SS L Top  
MSS - 50-350 psi 316SSL Top  
AR - Priming Valve  
90 - 90° Configuration

DIMENSIONS: PRM - Series			
All Materials		(Orifice size = 0.312)	
Size	A (in.)	B (in.)	C (in.)
1/4"	3.550	2.350	0.750
3/8"	3.550	2.350	0.750
1/2"	4.250	2.350	1.080

Note: Option MSS is only for use on 316SS, A20, & Hast C Valves.